

7WWW - 9WWW Automatic Tube Weld Tee-Cross ASME BPE

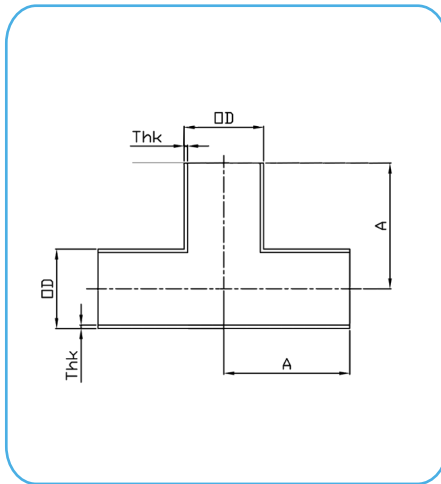

7WWW-TEE
BW x BW ASME BPE
DT-4.1.2-1

CODE	Size inch	OD X Thk (mm)	A (mm)
7WWW-A050-13A	1/2"	12.7 x 1.65	47.6
7WWW-A075-13A	3/4"	19.05 x 1.65	50.8
7WWW-A100-13A	1"	25.4 x 1.65	54.0
7WWW-A150-13A	1" 1/2	38.1 x 1.65	60.3
7WWW-A200-13A	2"	50.8 x 1.65	73.0
7WWW-A250-13A	2" 1/2	63.5 x 1.65	79.4
7WWW-A300-13A	3"	76.2 x 1.65	85.7
7WWW-A400-13A	4"	101.6 x 2.10	104.8
7WWW-A600-13A	6"	152.4 x 2.77	142.9

Technical Information:

Connections: Automatic Tube Weld according to ASME BPE (latest ed.)

Material: AISI 316L – 1.4404

Internal Surface Finish: SF1 Ra<=0.5µm → code **13** e.g.: 7WWW-A050-**13**A

Optional: SF4 Ra<=0.38µm Electropolish → code **43** e.g.: 7WWW-A050-**43**A

CODE	Size inch	OD X Thk (mm)	A (mm)
9WWWW-A050-13A	1/2"	12.7 x 1.65	47.6
9WWWW-A075-13A	3/4"	19.05 x 1.65	50.8
9WWWW-A100-13A	1"	25.4 x 1.65	54.0
9WWWW-A150-13A	1" 1/2	38.1 x 1.65	60.3
9WWWW-A200-13A	2"	50.8 x 1.65	73.0
9WWWW-A250-13A	2" 1/2	63.5 x 1.65	79.4
9WWWW-A300-13A	3"	76.2 x 1.65	85.7
9WWWW-A400-13A	4"	101.6 x 2.10	104.8
9WWWW-A600-13A	6"	152.4 x 2.77	142.9

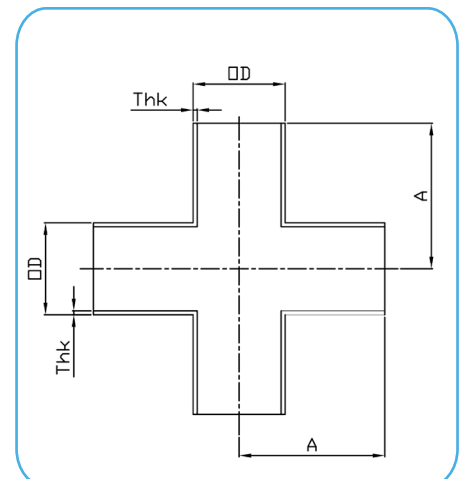

9WWW-CROSS
BW x BW ASME BPE
DT-4.1.2-1

DATASHEETS



Last updates can be found on our website - www.aerreinox.it
In the interests of development of the product, we reserve the right to change the specifications without prior notice